

Temperature Probe

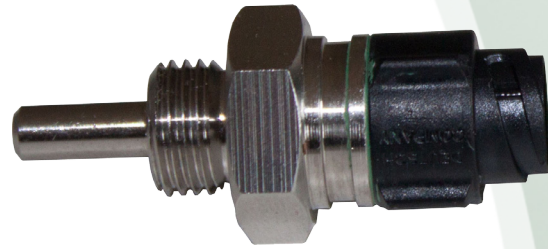

ETP-AM-SP-IMC-PT

- UL compliant
- Cost effective standard model
- Robust and compact design
- Fast response time
- Wide environmental temperature range



The ETP-AM-SP-IMC-PT temperature probe provides a cost-effective measurement solution where heat, dust and moisture are prevalent and where a compact and robust high-reliability design is required. The UL compliant sensor is particularly suitable for demanding temperature monitoring applications on vehicles but with its fast response time and wide environmental temperature range, it is equally well-equipped for measurement of liquids and gases used in medical equipment, test machinery, industrial instrumentation and process control systems.

Technical information

Element:	PT100B	PT1000A
Accuracy:	$\pm (0.3 \text{ K} + 0.005 \times t)$	$\pm (0.15 \text{ K} + 0.002 \times t)$
Working temperature:	-55°...+180 °C, short term 230 °C	
Environmental temperature:	-55°...+175 °C	
Sealing:	IP67	
Response time in still water t_{90} :	7 s	

Material:	
Housing:	316 stainless steel
Connector	Utem IMC11-2204X with gold pin 6860-201-22278
Weight:	16 g

Dimensions and wiring

Connector wiring:
 Pin 1 - Sensor leg 1
 Pin 2 - Sensor leg 1 LINK
 Pin 3 - Sensor leg 2 LINK
 Pin 4 - Sensor leg 2

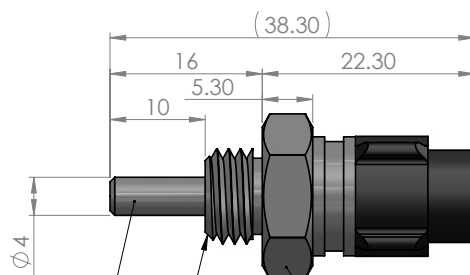

Elements available:
 PT100B RTD
 PT1000A RTD
 G10K3435 Thermistor

M10x1 Thread

Stainless Steel Housing

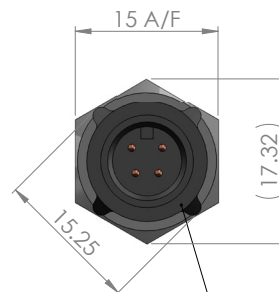
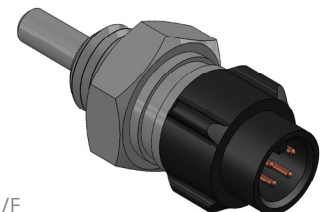

4 Pin IMC
 Male Connector
 IP67

Ordering Information

Order code: ETP-AM-SP-IMC-PT100B (93633)
ETP-AM-SP-IMC-PT1000A (93634)

Accessories

Mating connector kit: ETP-AM-SP IMC Connector Kit (93632)



Cable kit: ETP-AM-SP IMC Cable Kit (93639)



Mating connector with 1m cable:	ETP-AM-SP IMC 1m Cable Kit (93639)
Material:	Raychem 55 AWG 24, Raychem DR-25
Environmental temperature:	-55 ...+150 °C

Dimensions and wiring for 93639 cable kit

